

AVAILABLE

2.3 ACRES Commercial Land

3807 Providence Rd South/WAXHAW



2.3 Acres commercial land
Fastest growing county in NC
Traffic Ct 19,000 daily
Zoning C1
Many allowed uses
Sale/lease
Land lease preferred
Will subdivide
Call for pricing



Jim McAuliffe
704 618-2441
jmack@newmarketproperties.biz

AVAILABLE

2.3 ACRES Commercial Land

3807 Providence Rd South/WAXHAW

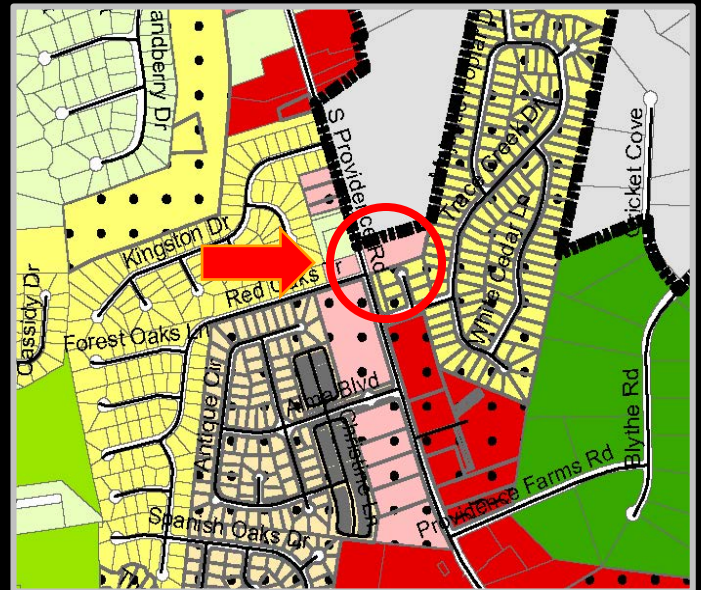

Adjacent Land under contract

Only Commercial Parcel on East side of Providence Rd

2.3 Acres commercial land

Zoning C1

Many allowed uses

Sale/lease

Land lease preferred

Will subdivide

Call for pricing



Jim McAuliffe

704 618-2441

jmack@newmarketproperties.biz

AVAILABLE

2.3 ACRES Commercial Land

3807 Providence Rd South/WAXHAW

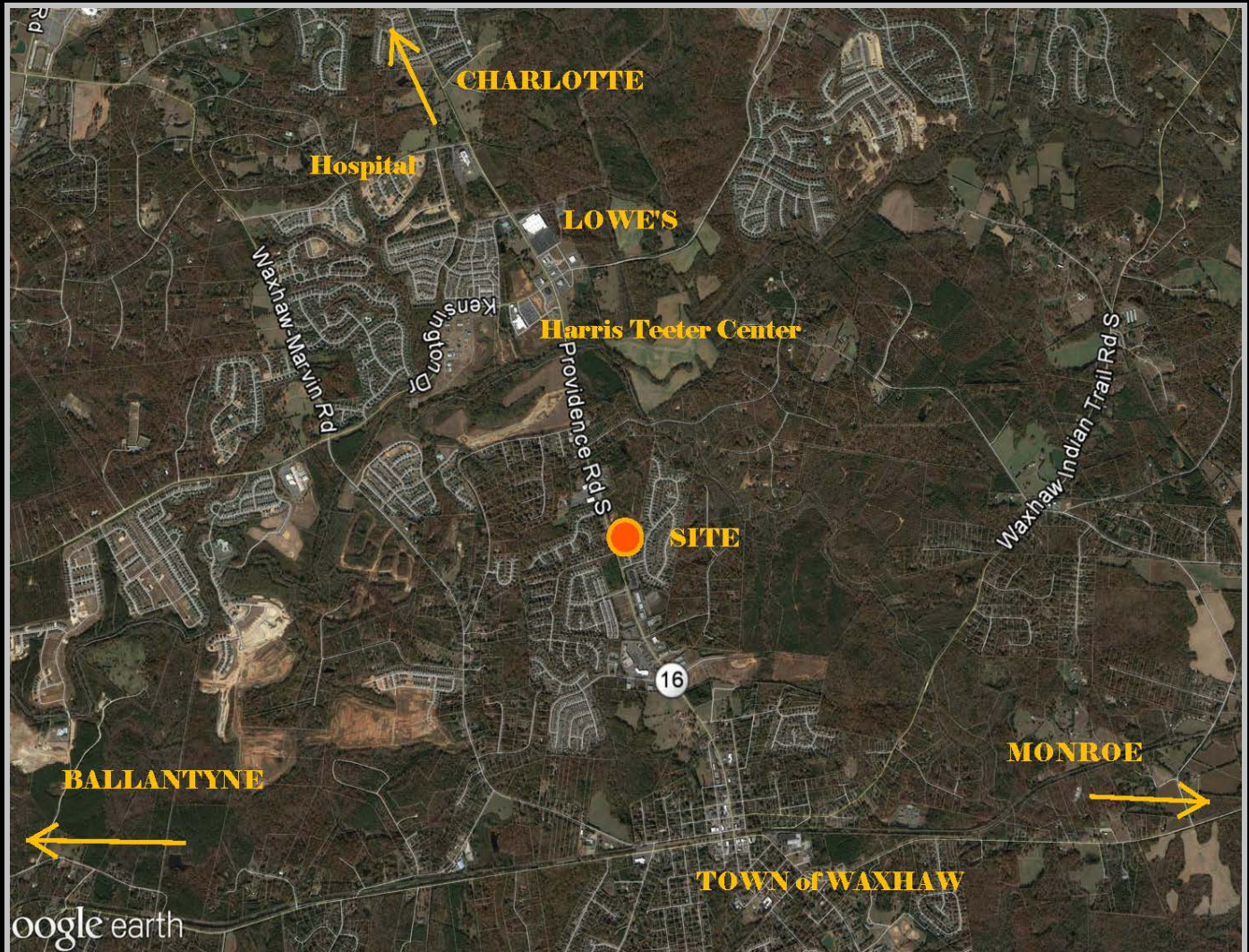

Well positioned parcel on Providence Road between Charlotte NC and historic town of Waxhaw, close proximity to Ballantyne, Marvin and Monroe NC. Many rooftops in the area, with more coming. Purchase/lease commercial land in the path of progress



Jim McAuliffe
704 618-2441
jmack@newmarketproperties.biz

AVAILABLE

2.3 ACRES Commercial Land

3807 Providence Rd South/WAXHAW

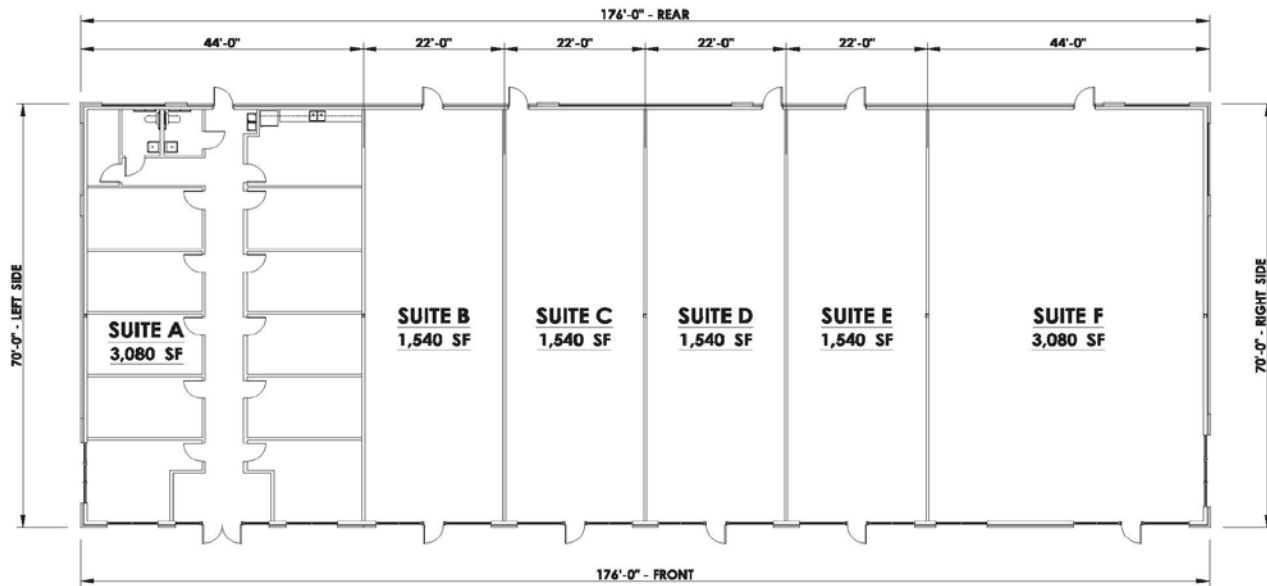

CONCEPTUAL FLOOR PLAN

One Allowed Use: Shopping Center



Jim McAuliffe
704 618-2441
jmack@newmarketproperties.biz