

Rock Creek Center

Whitsett, NC

AVAILABLE



Lot 16 - Rock Creek Center

Whitsett, North Carolina

9.8 ± Acres

All information provided regarding property for sale, lease, or financing is from sources deemed reliable, but no warranty or representation is made as to the accuracy thereof and same is submitted subject to errors, omissions, change of price, lease or other conditions, prior sale, lease or financing or withdrawal without notice. No liability of any kind is to be imposed on the broker herein.

**SCHULMAN
& BEARD**
COMMERCIAL REAL ESTATE

125 South Elm Street, Suite 403
Greensboro, NC 27401
336.282.3773 www.ssbre.com

Rock Creek Center

Whitsett, NC

Type of Property	Land
# Acres of Site	9.8 ±
Topography	Level
Type of Location	Business Park
Industrial / Business Park	Rock Creek Center
Zoning	Light Industrial
In City Limits?	No
Former Use	Vacant land
Available Due Diligence	Minimal
Access Road	Rock Creek Dairy Rd.
Nearest Interstate/Highway	Interstates 40 & 85 - < 1 mile

Area Airports	GSO - 23 miles RDU - 53 miles
Rail Access?	None
Utilities/Providers	Electricity Duke Energy Natural Gas Piedmont Natural Gas Telecommunications AT&T, Level 3 Water City of Greensboro Waste Water City of Greensboro
Sale Price per Acre	\$65,000.00
Availability	Immediately

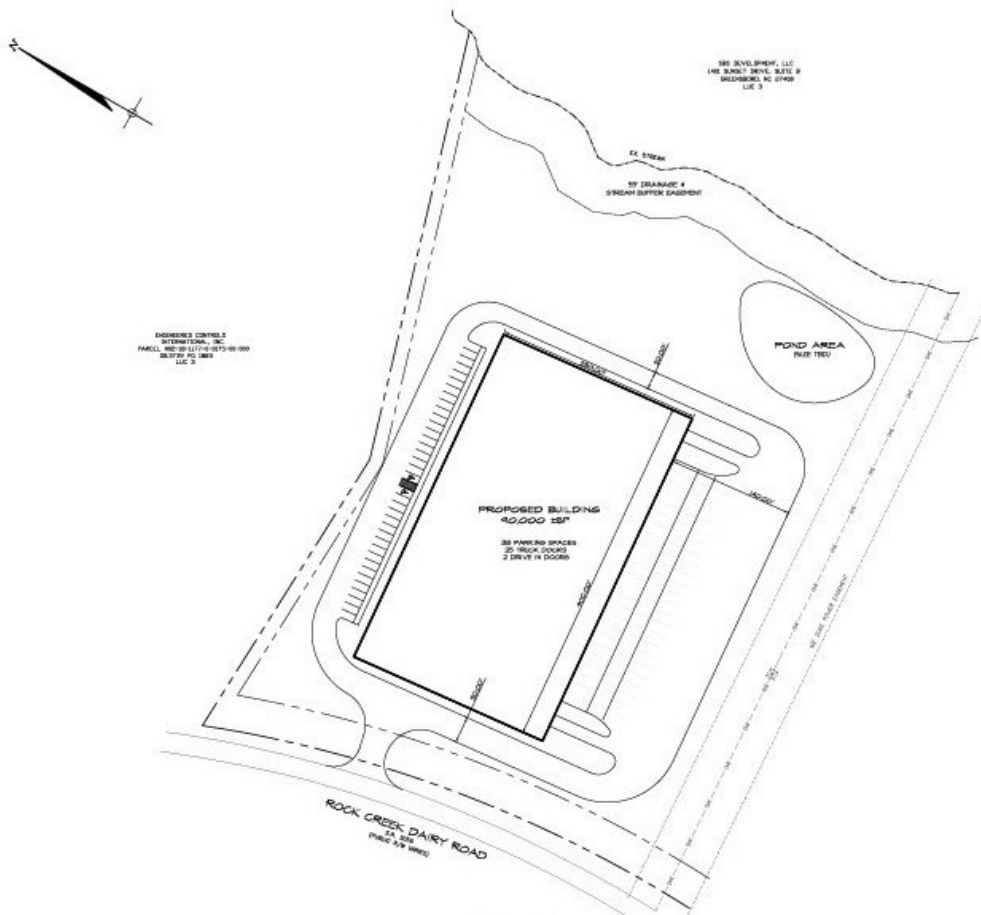

For more information, please contact:

Brett Schulman
Partner
(mobile) 336-508-2800
Brett@ssbre.com

T. Richard Beard
Partner
(mobile) 336-202-8383
Richard@ssbre.com

**SCHULMAN
& BEARD**
COMMERCIAL REAL ESTATE

125 South Elm Street, Suite 403
Greensboro, NC 27401
336.282.3773 www.ssbre.com

All information provided regarding property for sale, lease, or financing is from sources deemed reliable, but no warranty or representation is made as to the accuracy thereof and same is submitted subject to errors, omissions, change of price, lease or other conditions, prior sale, lease or financing or withdrawal without notice. No liability of any kind is to be imposed on the broker herein.

Whitsett, NC

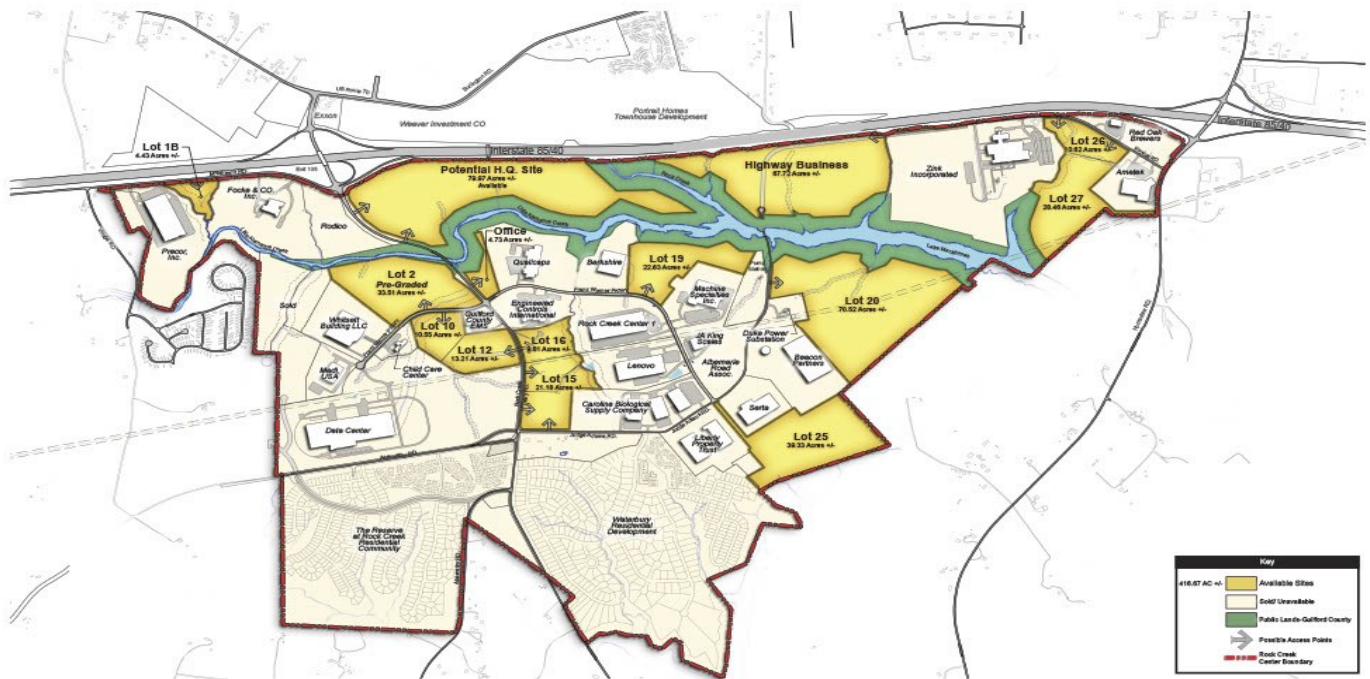

Prepared For:
**SCHULMAN
& BEARD**
COMMERCIAL REAL ESTATE
August 4, 2010 | #16-150

Master Plan
Rock Creek Center
Guilford County, NC

 LA NERG CAPS ARCHITECTURE
3100 20th Street
Largo, FL 33470
601 N. Trade Street, Suite 2100
Wilmington, DE 19801
www.stimmelgroup.com 301.703.1067



For more information, please contact:

Brett Schulman

Partner

(mobile) 336-508-2800

Brett@ssbre.com

T. Richard Beard

Partner

(mobile) 336-202-8383

Richard@ssbre.com

**SCHULMAN
& BEARD**
COMMERCIAL REAL ESTATE

125 South Elm Street, Suite 403

Greensboro, NC 27401

336.282.3773 www.ssbre.com

All information provided regarding property for sale, lease, or financing is from sources deemed reliable, but no warranty or representation is made as to the accuracy thereof and same is submitted subject to errors, omissions, change of price, lease or other conditions, prior sale, lease or financing or withdrawal without notice. No liability of any kind is to be imposed on the broker herein.