

For Lease

NE Heights Medical/Dental Office

PENN-MONT PROFESSIONAL PLAZA

7520 Montgomery Blvd. NE | Suite D-4 | Albuquerque, NM 87110

SWQ Montgomery Blvd. & Pennsylvania St. NE



Suite D-4
±4,130 SF



\$15.50/SF
Full Service

PROPERTY HIGHLIGHTS

- Five to six exam rooms with sinks
- In-suite restrooms

- Plenty of storage
- Full basement with kitchen
- Plenty of amenities nearby

NASunVista

got space

FOR MORE INFORMATION:

Lisa Mercer
lisa@sunvista.com
505 235 8503

Martha Carpenter
martha@sunvista.com
505 228 0154

For Lease

NE Heights Medical/Dental Office

PENN-MONT PROFESSIONAL PLAZA

7520 Montgomery Blvd. NE | Suite D-4 | Albuquerque, NM 87110



LOCATION

| Demographics | 1 mile | 3 mile | 5 mile |
|--------------------|----------|----------|----------|
| Total Population | 14,824 | 134,554 | 302,625 |
| Average HH Income | \$81,338 | \$74,394 | \$80,174 |
| Daytime Employment | 4,735 | 84,444 | 205,036 |

2021 Forecasted by Esri

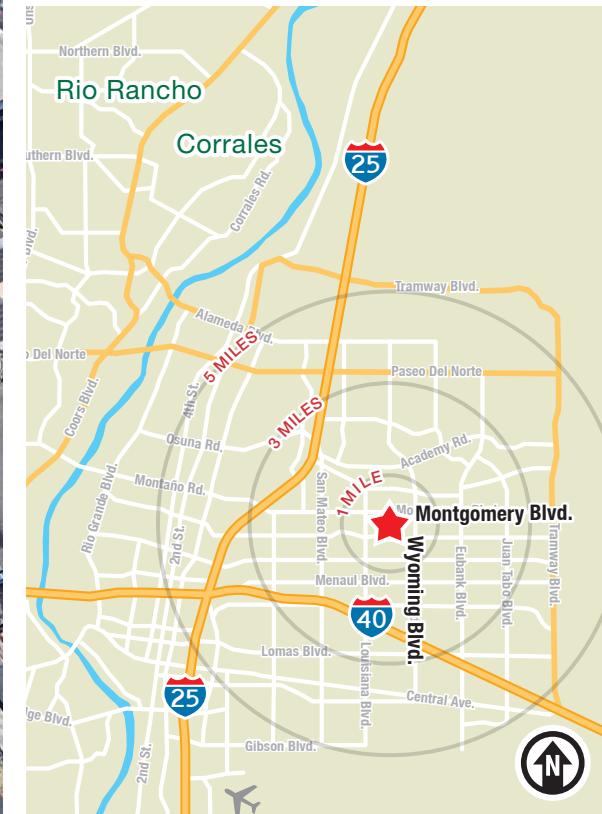

6801 Jefferson St. NE | Suite 200 | Albuquerque, NM 87109 **505 878 0001** sunvista.com

The information contained is believed reliable. While we do not doubt the accuracy, we have not verified it and make no guarantee, warranty or representation about it. It is your responsibility to independently confirm its accuracy and completeness. Any projection, opinion, assumption or estimated uses are for example only and do not represent the current or future performance of the property. The value of this transaction to you depends on many factors which should be evaluated by your tax, financial, and legal counsel. You and your counsel should conduct a careful independent investigation of the property to determine that it is suitable to your needs.

FOR MORE INFORMATION:

Lisa Mercer
lisa@sunvista.com
505 235 8503

Martha Carpenter
martha@sunvista.com
505 228 0154

For Lease

NE Heights Medical/Dental Office

PENN-MONT PROFESSIONAL PLAZA

7520 Montgomery Blvd. NE | Suite D-4 | Albuquerque, NM 87110

LOCATION

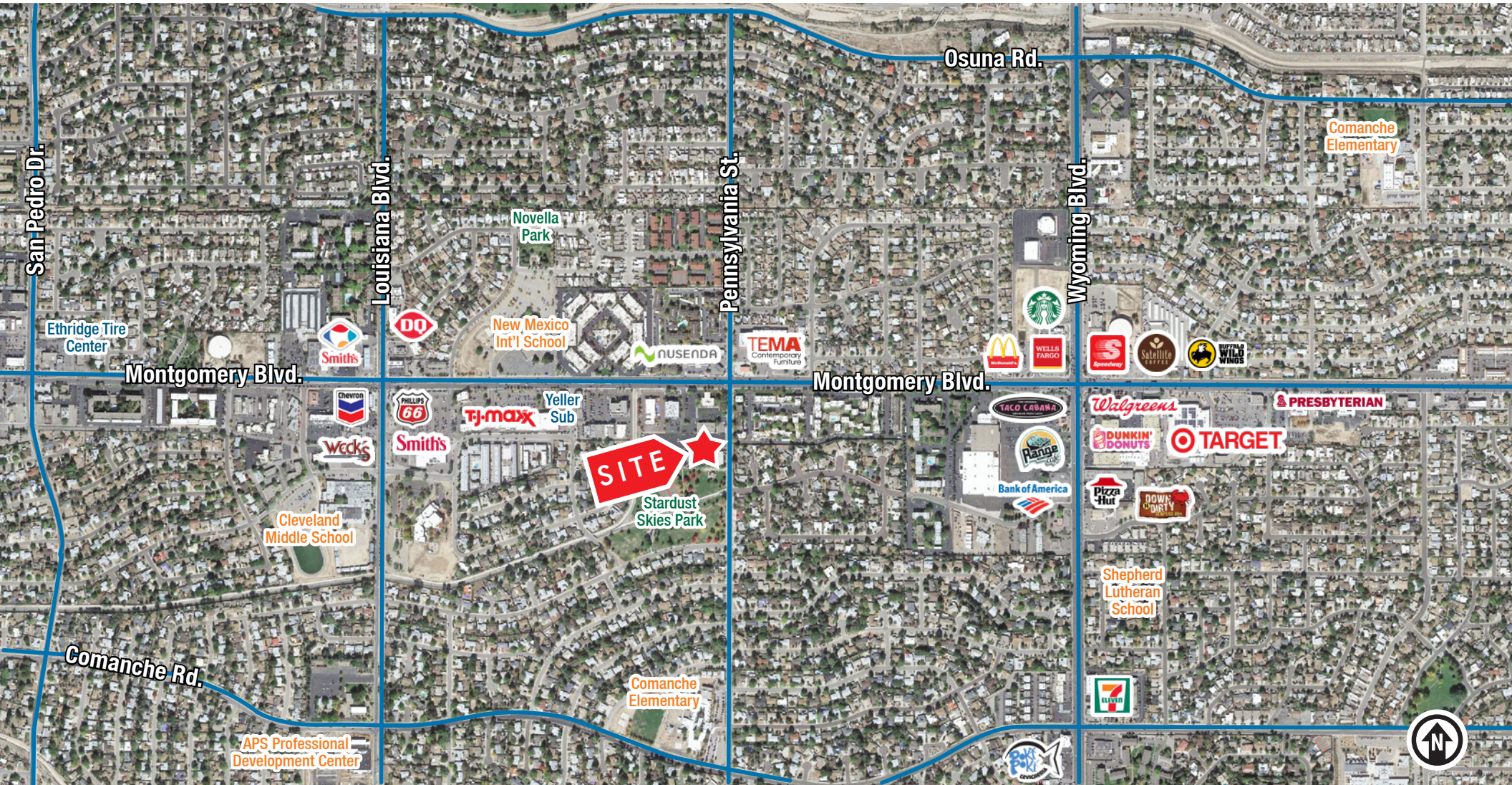

NA SunVista    

6801 Jefferson St. NE | Suite 200 | Albuquerque, NM 87109 **505 878 0001** sunvista.com

The information contained is believed reliable. While we do not doubt the accuracy, we have not verified it and make no guarantee, warranty or representation about it. It is your responsibility to independently confirm its accuracy and completeness. Any projection, opinion, assumption or estimated uses are for example only and do not represent the current or future performance of the property. The value of this transaction to you depends on many factors which should be evaluated by your tax, financial, and legal counsel. You and your counsel should conduct a careful independent investigation of the property to determine that it is suitable to your needs.

FOR MORE INFORMATION:

Lisa Mercer
lisa@sunvista.com
505 235 8503

Martha Carpenter
martha@sunvista.com
505 228 0154

For Lease

NE Heights Medical/Dental Office

PENN-MONT PROFESSIONAL PLAZA

7520 Montgomery Blvd. NE | Suite D-4 | Albuquerque, NM 87110

PHOTOS



NA SunVista    

6801 Jefferson St. NE | Suite 200 | Albuquerque, NM 87109 **505 878 0001** sunvista.com

The information contained is believed reliable. While we do not doubt the accuracy, we have not verified it and make no guarantee, warranty or representation about it. It is your responsibility to independently confirm its accuracy and completeness. Any projection, opinion, assumption or estimated uses are for example only and do not represent the current or future performance of the property. The value of this transaction to you depends on many factors which should be evaluated by your tax, financial, and legal counsel. You and your counsel should conduct a careful independent investigation of the property to determine that it is suitable to your needs.

FOR MORE INFORMATION:

Lisa Mercer
lisa@sunvista.com
505 235 8503

Martha Carpenter
martha@sunvista.com
505 228 0154

For Lease

NE Heights Medical/Dental Office

PENN-MONT PROFESSIONAL PLAZA

7520 Montgomery Blvd. NE | Suite D-4 | Albuquerque, NM 87110

SUITE D-4



6801 Jefferson St. NE | Suite 200 | Albuquerque, NM 87109 **505 878 0001** sunvista.com

The information contained is believed reliable. While we do not doubt the accuracy, we have not verified it and make no guarantee, warranty or representation about it. It is your responsibility to independently confirm its accuracy and completeness. Any projection, opinion, assumption or estimated uses are for example only and do not represent the current or future performance of the property. The value of this transaction to you depends on many factors which should be evaluated by your tax, financial, and legal counsel. You and your counsel should conduct a careful independent investigation of the property to determine that it is suitable to your needs.

FOR MORE INFORMATION:

Lisa Mercer
lisa@sunvista.com
505 235 8503

Martha Carpenter
martha@sunvista.com
505 228 0154

For Lease

NE Heights Medical/Dental Office

PENN-MONT PROFESSIONAL PLAZA

7520 Montgomery Blvd. NE | Suite D-4 | Albuquerque, NM 87110

SUITE D-4

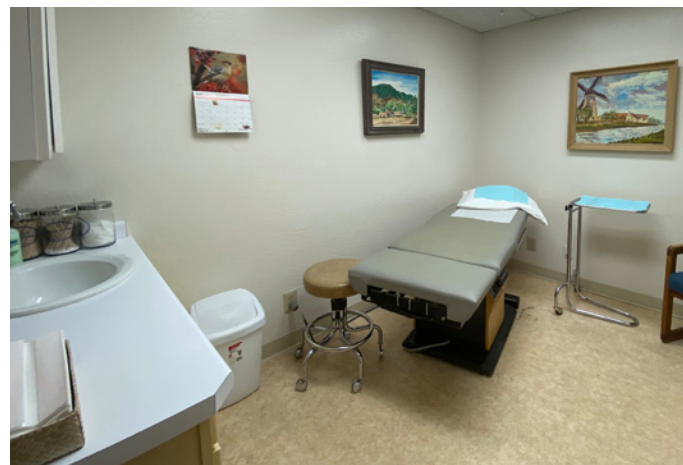

NA SunVista    

6801 Jefferson St. NE | Suite 200 | Albuquerque, NM 87109 **505 878 0001** sunvista.com

The information contained is believed reliable. While we do not doubt the accuracy, we have not verified it and make no guarantee, warranty or representation about it. It is your responsibility to independently confirm its accuracy and completeness. Any projection, opinion, assumption or estimated uses are for example only and do not represent the current or future performance of the property. The value of this transaction to you depends on many factors which should be evaluated by your tax, financial, and legal counsel. You and your counsel should conduct a careful independent investigation of the property to determine that it is suitable to your needs.

FOR MORE INFORMATION:

Lisa Mercer
lisa@sunvista.com
505 235 8503

Martha Carpenter
martha@sunvista.com
505 228 0154